

DEMASLED

TUV LED Downlight

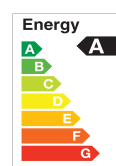

DEMASLED

Light Features



★ High efficiency, materials from Japan and improves more than 25% of light effect

★ adopts 2835 SMD led source, 0.5W

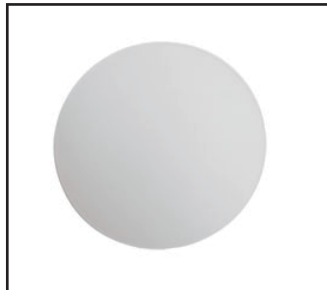

★ Diffuser plate is imported

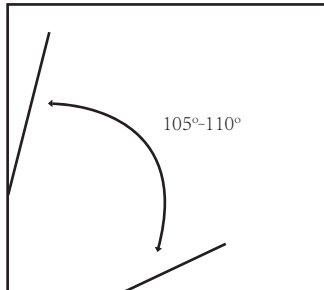

★ Lighting angle: 105°-110°

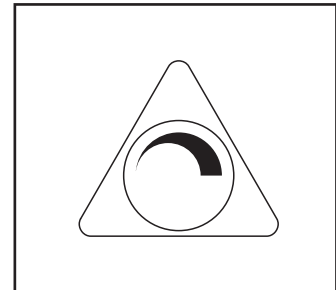

★ Triac dimming

Light Dimension

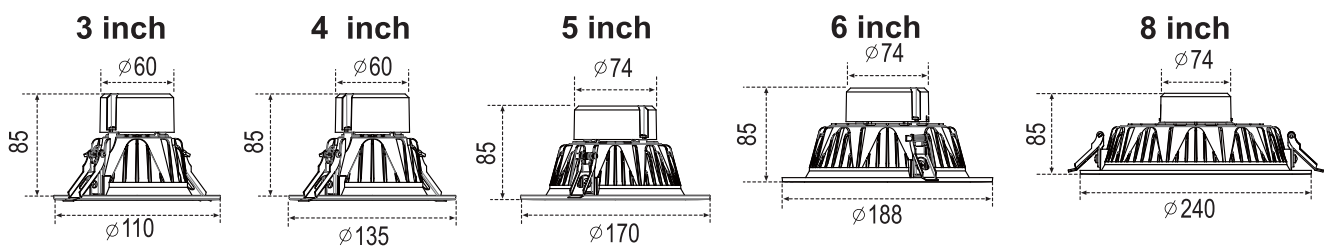

(unit : mm)

Installation hole size:

3 inch: \varnothing 90mm
4 inch: \varnothing 110mm
5 inch: \varnothing 140mm
6 inch: \varnothing 165mm
8 inch: \varnothing 215mm

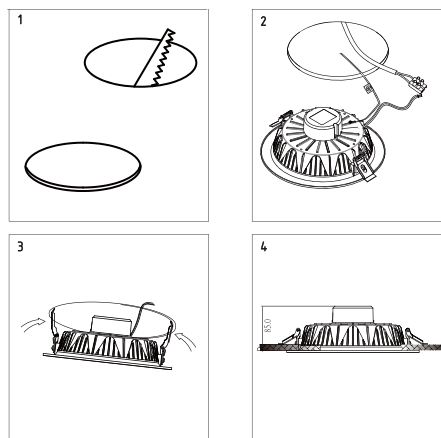

DEMASLED

Light Parameters

Working Voltage	100-240Vac or 180-246Vac
Junction Temperature	125°C
Lamp's Luminous Efficiency	85-90LM/W
Color Rendering Index	Ra>80
Operating Temperature	-20°C ~ +40°C
Storage Temperature	-30°C ~ +50°C
IP Grade	IP20
Life-span(hrs)	≥35000H
Materials	ADC12
Color of the lamp shell	White
Installation	Recessed install

Part No.	LED Qty	Color	Color Temperature	Power (W)	Luminous flux (lm)
10W	12	Warm white Natural white White	3045±275K (Warm white) 3985±175K (Natural white) 5028±283K (White)	10W	750lm±10%
10W	24			10W	800lm±10%
15W	36			15W	1250lm±10%
20W	48			20W	1800lm±10%
20W	48			20W	2750lm±10%
30W	72			30W	2750lm±10%
10W-D	12	Warm white Natural white White	3045±275K (Warm white) 3985±175K (Natural white) 5028±283K (White)	10W	750lm±10%
10W-D	24			10W	800lm±10%
15W-D	36			15W	1250lm±10%
20W-D	48			20W	1800lm±10%
20W-D	48			20W	2750lm±10%
30W-D	72			30W	2750lm±10%

DEMASLED

Power Supply Features

Part No	Input Voltage	Input Current	Output Voltage	Power Factor
10W	100-240V	125mA+5%	65-80V	0.9
10W		125mA \pm 5%	65-80V	
15W		250mA \pm 5%	50-60V	
20W		250mA \pm 5%	65-80V	
20W		250mA \pm 5%	65-80V	
30W		375mA \pm 5%	65-80V	
10W-D	180-264V	125mA+5%	65-80V	0.9
10W-D		125mA \pm 5%	65-80V	
15W-D		250mA \pm 5%	50-60V	
20W-D		250mA \pm 5%	65-80V	
20W-D		250mA \pm 5%	65-80V	
30W-D		375mA \pm 5%	65-80V	

Optical Properties

Distribution curve flux and temperature test (RDL03-10W)

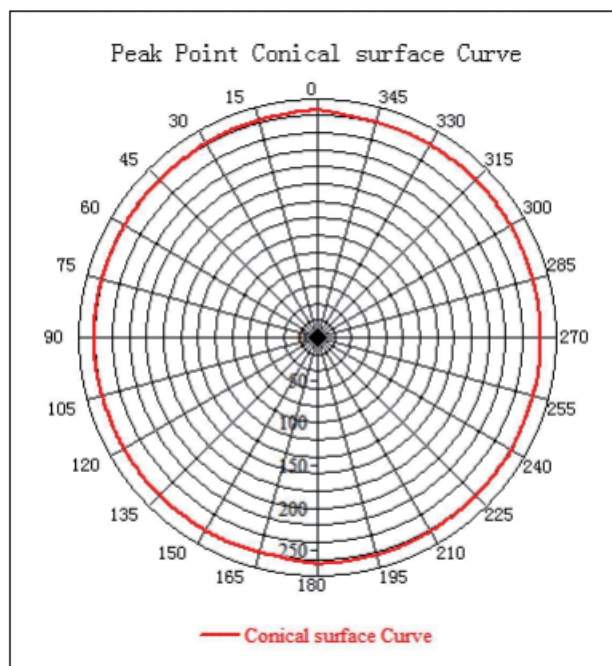
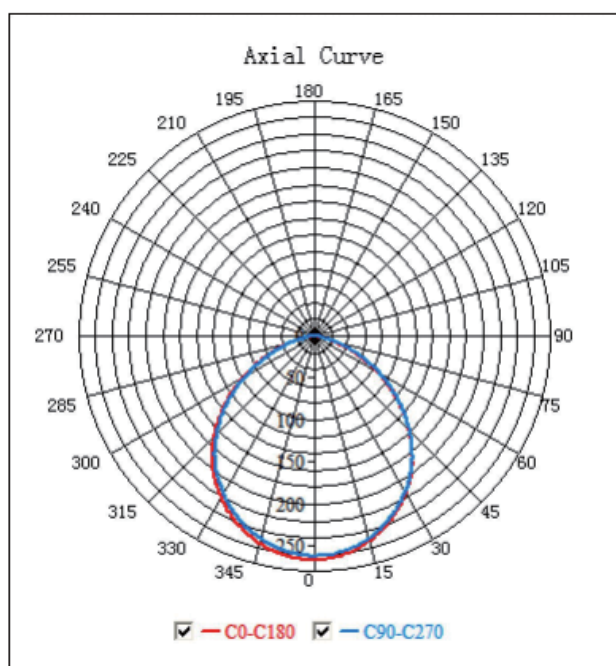

DEMASLED

Distribution curve flux and temperature test (RDL04-10W)

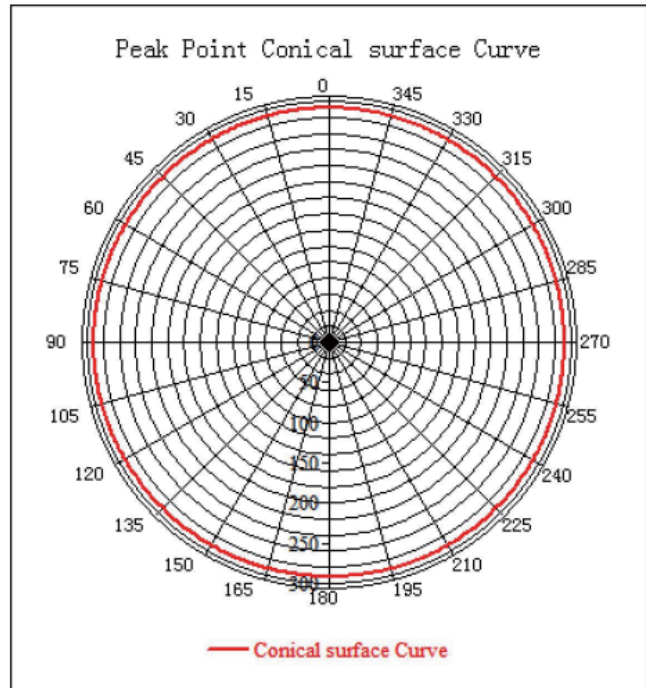
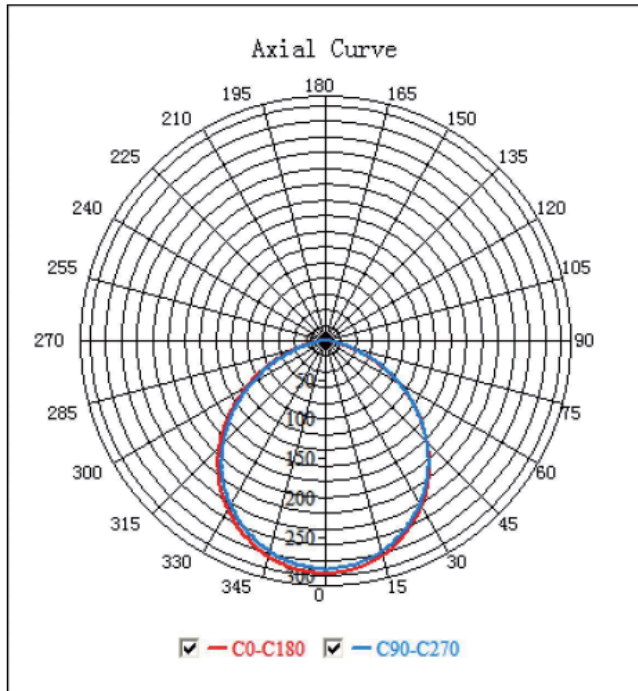

Distribution curve flux and temperature test (RDL05-15W)

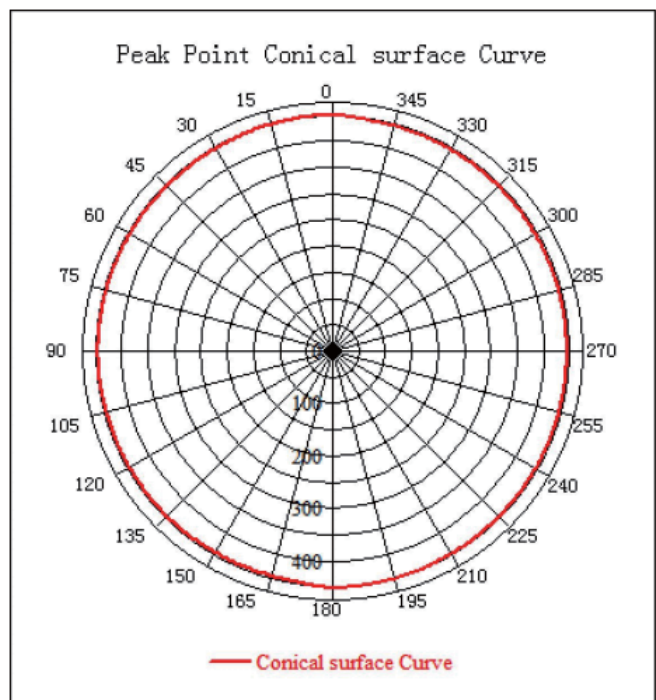
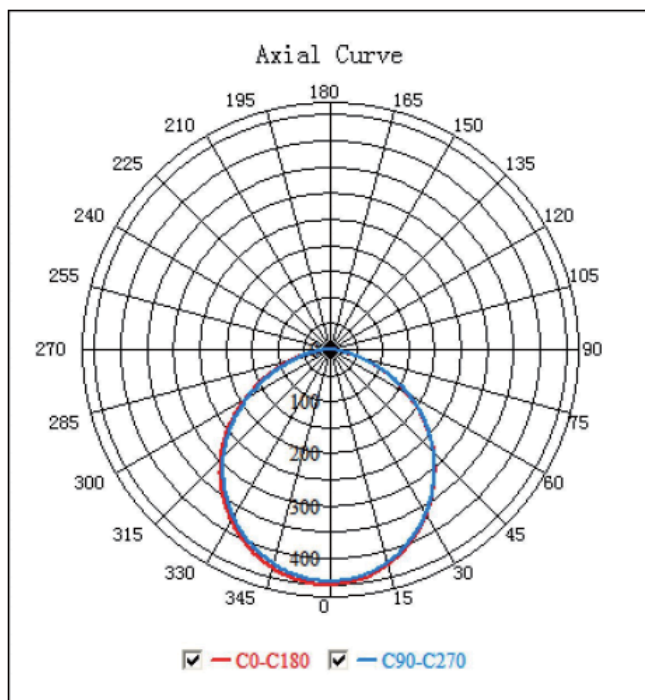

DEMASLED

Distribution curve flux and temperature test (RDL06-20W)

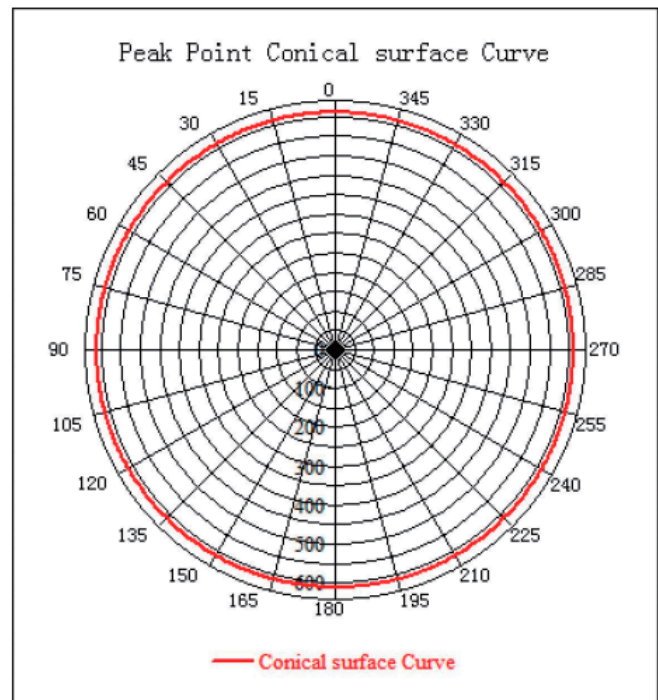
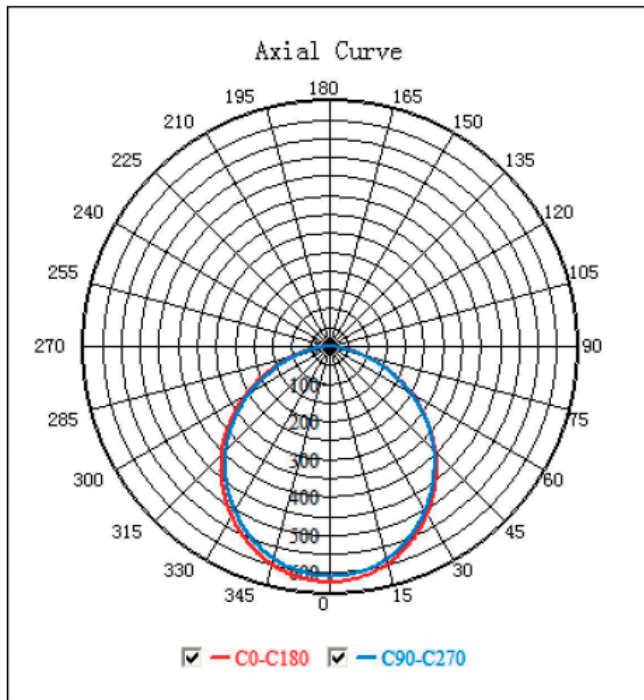

Distribution curve flux and temperature test (RDL08-20W)

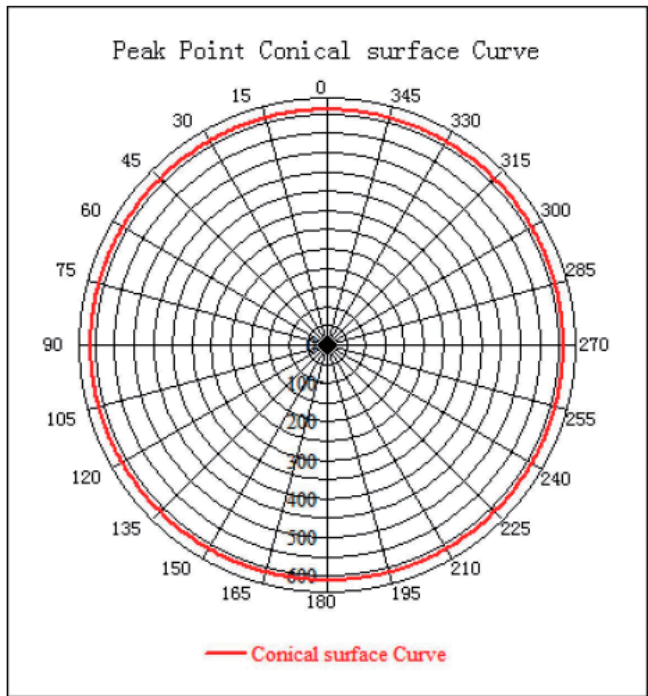
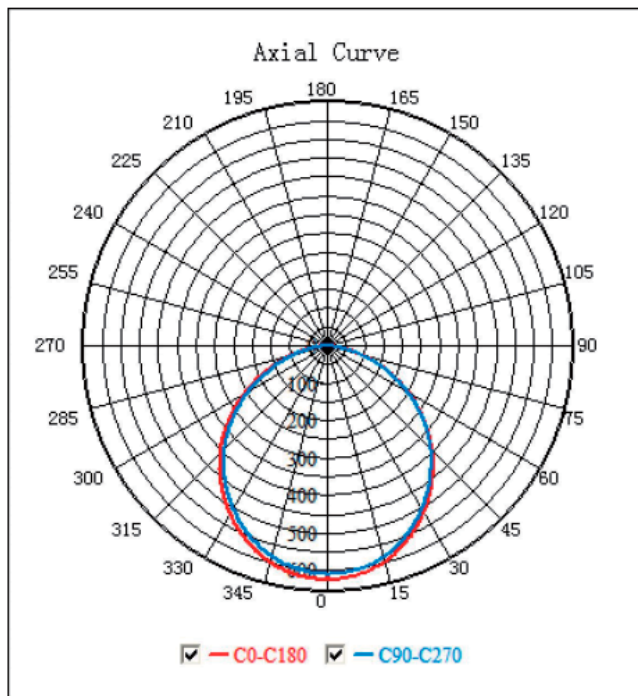

DEMASLED

Distribution curve flux and temperature test (RDL08-30W)

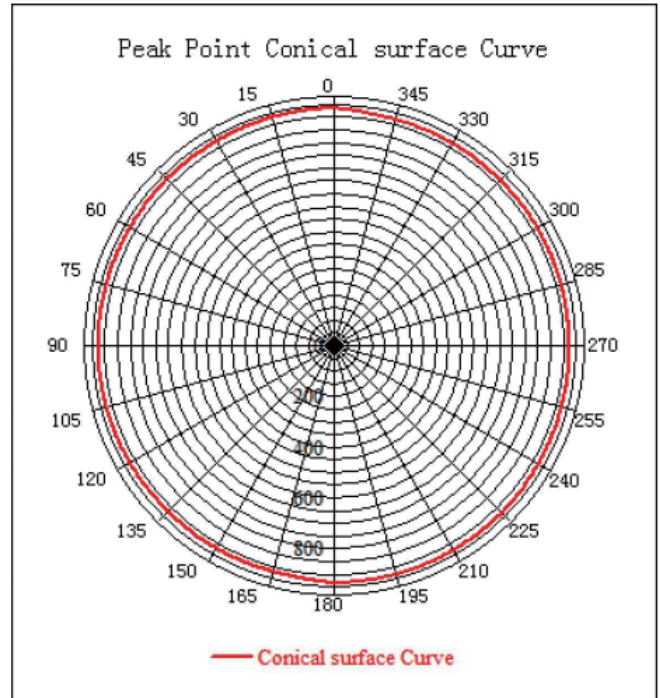
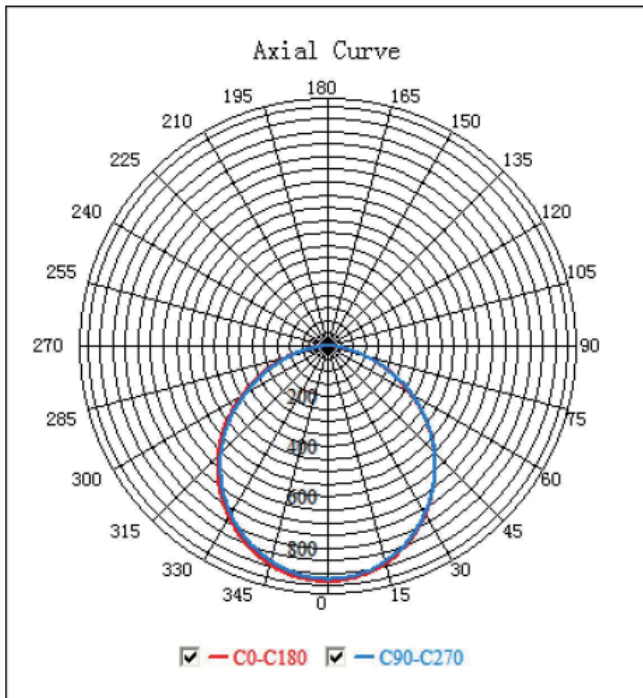

Product Applications



- Widespread use in Family, School
- Commercial Building, Tower, Hotel, Restaurant
- Pathway lighting,
- Office, Showing Room, Meeting Room
- Factory, Production Line, Warehouse
- Subway station, bus and train

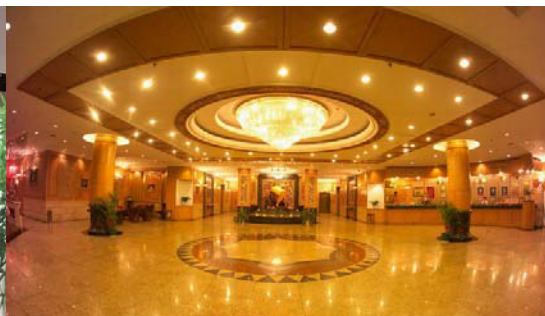

DEMASLED

Packing /weight

Part No	Inner box (W*L*H)	Outer box (W*L*H)	Qty/Ctn	N.W/pcs	G.W/Ctn
3 inch	125*125*95mm	390*265*400 mm	24pcs	0.17kg	6.72kg
4 inch	150*150*95mm	465*315*400mm	24pcs	0.28kg	9.42kg
5 inch	185*185*95mm	385*385*400mm	16pcs	0.41kg	8.78kg
6 inch	203*203*95mm	421*421*400mm	16pcs	0.49kg	10.52kg
8 inch	255*255*95mm	525*525*400mm	16pcs	0.75kg	14.8kg

Package Diagram



DEMASLED

Electrical Connection

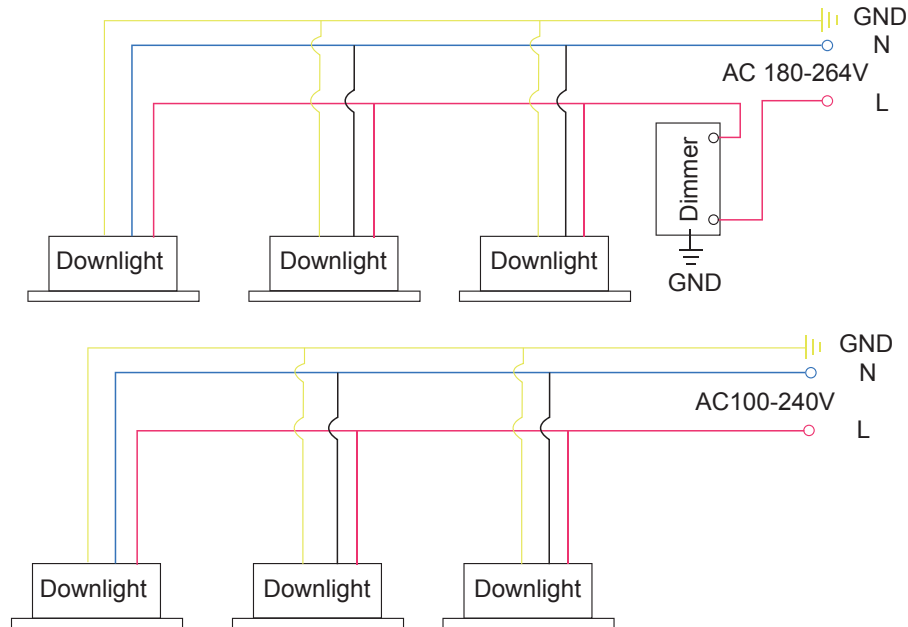

Installation Instruction

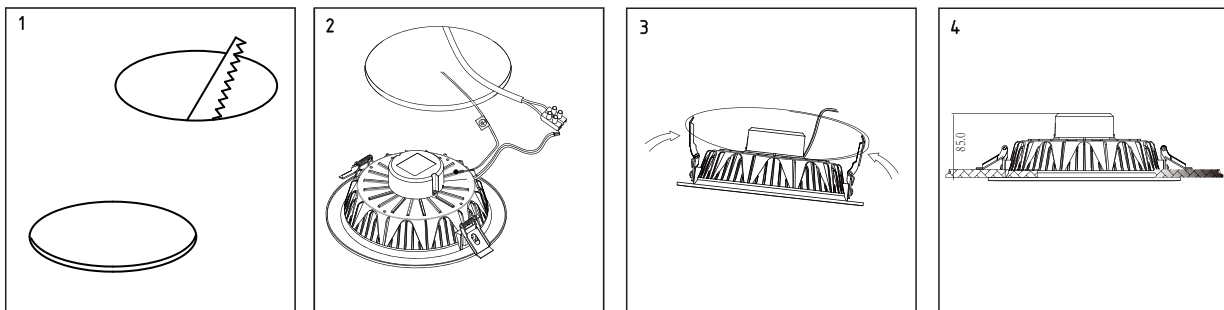

Warning

1. Please find the professionals to install the lamp.
2. When the input voltage exceeds the standard range, it will cause a failure of down light.
3. Please use the down light under the circumstance: $-20^{\circ}\text{C} \sim 40^{\circ}\text{C}$
4. Using under a high temperature circumstance will reduce the lifespan, please consult more details from local distributor.
5. When installing on a traditional lighting fixture, it's necessary to change the circuitry ,please contact the professionals to operate.
6. Dry location using ONLY.
7. No cover on product, which easy cause a fire.
8. Cut off the power before installation and replacing.